

6th Gen Toyota 4Runner Super Stock Covert Front Bumper

Installation Instructions



Install time: ~4 - 6 Hours

Step 1: Remove Front Clip

Lift the hood

Remove plastic clips to pull covers off, remove screws holding the front clip to the vehicle structure from the top

Remove factory air dam and lower cover from underneath the clip

Remove plastic clips and screws holding fender liners and fender flares in place

Reach in behind fender flares to release clips holding them on, the fender flares will not need to be completely removed, just pulled enough to allow for the clip to be removed

Unplug wiring harnesses going to fog lights, parking sensors, etc.

Carefully detach the front clip from the vehicle and set it aside on a non-damaging surface

Step 2: Disassembly Clip and Cut Plastics

Remove plastic clips and any small screws to pull the cover from the lower part of the front clip where the super stock front bumper will sit

Using a dremel, small cutting wheel, or oscillating cutting tool, carefully cut away the plastic around where the super stock covert will be located

Deburr and sand any rough edges, painters tape is recommended to protect surrounding surfaces

Reference the image below, a video is available for reference showing the CBI technician making this cut

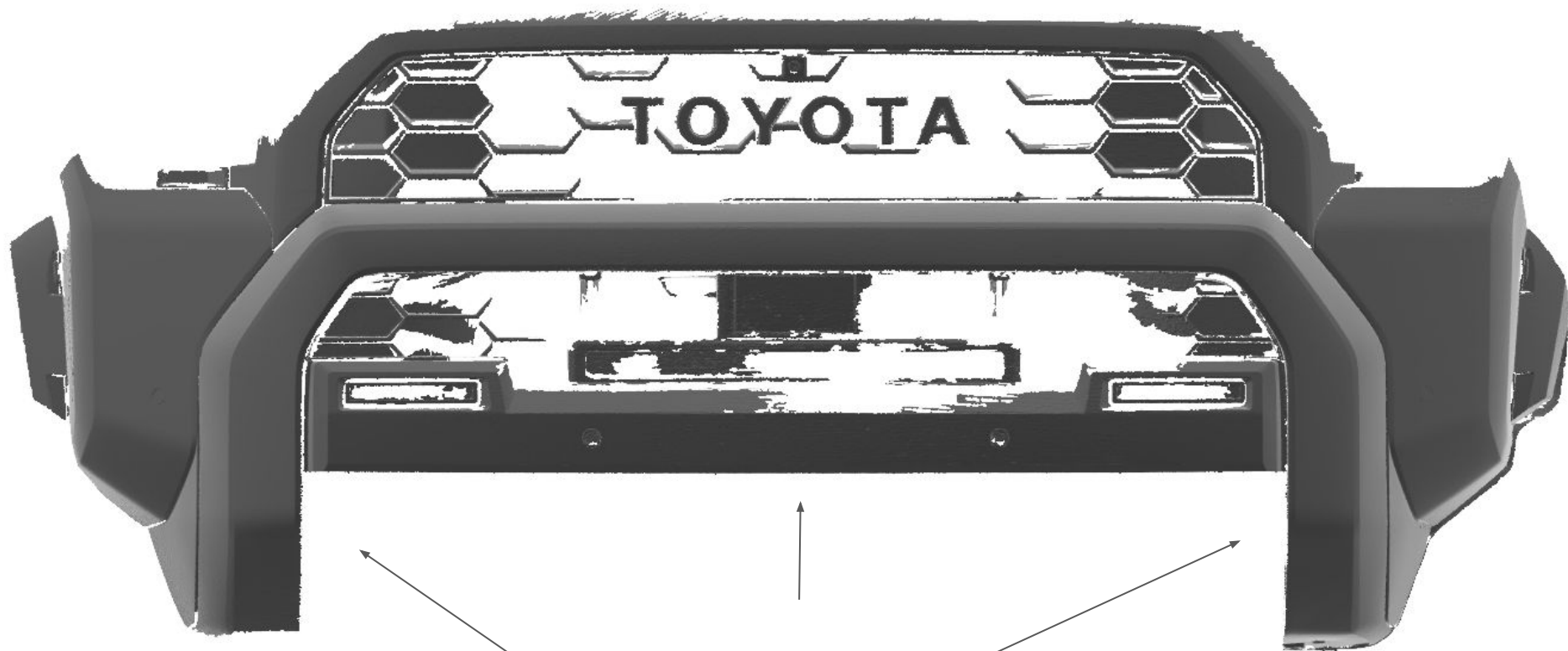

Cut plastics here

Remove the front clip support bracket (shown below)

Remove the plastic clip retainers from the ends of the bracket, these will be relocated onto the supplied plastic support brackets

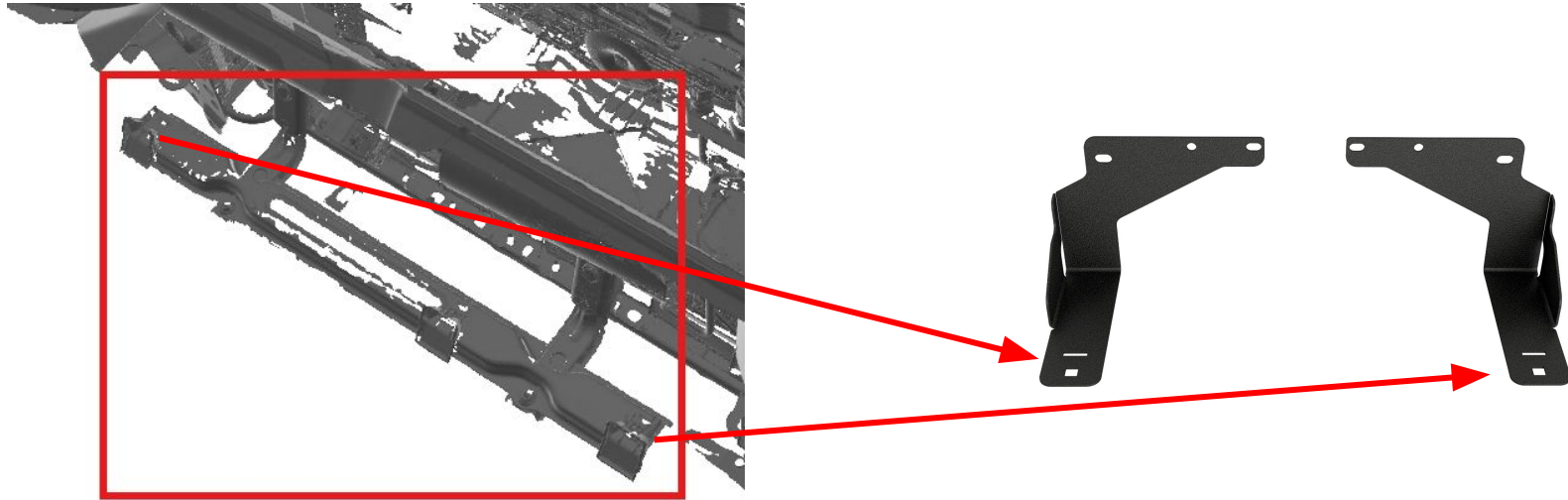

Pull the crash bar off by removing (4) M12 bolts from the frame ends, these will be reused

Step 3: Assemble Super Stock Covert

Prepare the superstock front bumper for installation by mounting any aftermarket accessories including a winch and lighting

Below is a list of included hardware with the Super Stock Covert Bumper, the hardware is broken down into three categories: mounting hardware, upper plastic support bracket hardware, and side plastic support bracket hardware

6th Gen Toyota 4Runner Super Stock Covert Hardware List

WHERE USED	DESCRIPTION	QUANTITY
Frame Mounting - Front/Top		
	1/2"-13 x 1" Steel Hex Cap Screw Zinc	4
	1/2"-13 x 1-1/4" Steel Hex Cap Screw Zinc	2
	1/2" x 1.062" Steel Flat Washer	8
	1/2"-13 Steel Hex Flange Nut Zinc	6
Upper Plastic Support Brackets		
	M6-1.0 x 20 mm Steel Hex Cap Screw Flange Zinc	6
Side Plastic Support Brackets		
	1/4"-20 x 3/4" Steel Carriage Bolt Zinc	4
	1/4" x .625" x .0625" Stainless Steel Flat Black Oxide Washer	4
	1/4"-20 Stainless Steel Nylon Insert Nut Black Oxide	4
	M6x1 Zinc Plated Class 8 DIN 6926 Hex Flange Nut w/ Nylon Insert	2

ADDITIONAL ITEMS

ITEM:	DESCRIPTION	Additional Info	QTY
Grill Support Brackets	6th Gen Toyota 4Runner Grill Support Brackets	*Manufactured in Pairs	1 Set
Side Plastic Support Brackets	6th Gen Toyota 4Runner Side Plastic Support Brackets	*Manufactured in Pairs	1 Set

Step 4: Bolt the Bumper onto the Vehicle

Lift the bumper into place against the frame ends, insert the included $\frac{1}{2}$ "-13 x 1" mounting bolts (with washers) down through the upper face of the frame ends and through the mounting brackets on the bumper, thread the $\frac{1}{2}$ "-13 flange nuts onto the bolts

Thread the factory M12s from the crash bar into the front face of the bumper mounting brackets

The $\frac{1}{2}$ "-13 x 1- $\frac{1}{4}$ " mounting bolts will be used for the thru-hole on the frame end, use washers and the included flange nuts

Ensure the bumper is centered and tighten all mounting bolts, anti seize is recommended for the factory bolts

****Note:** Additional washers have been supplied to be used to shim either side if the body of the vehicle is not perfectly aligned with the frame

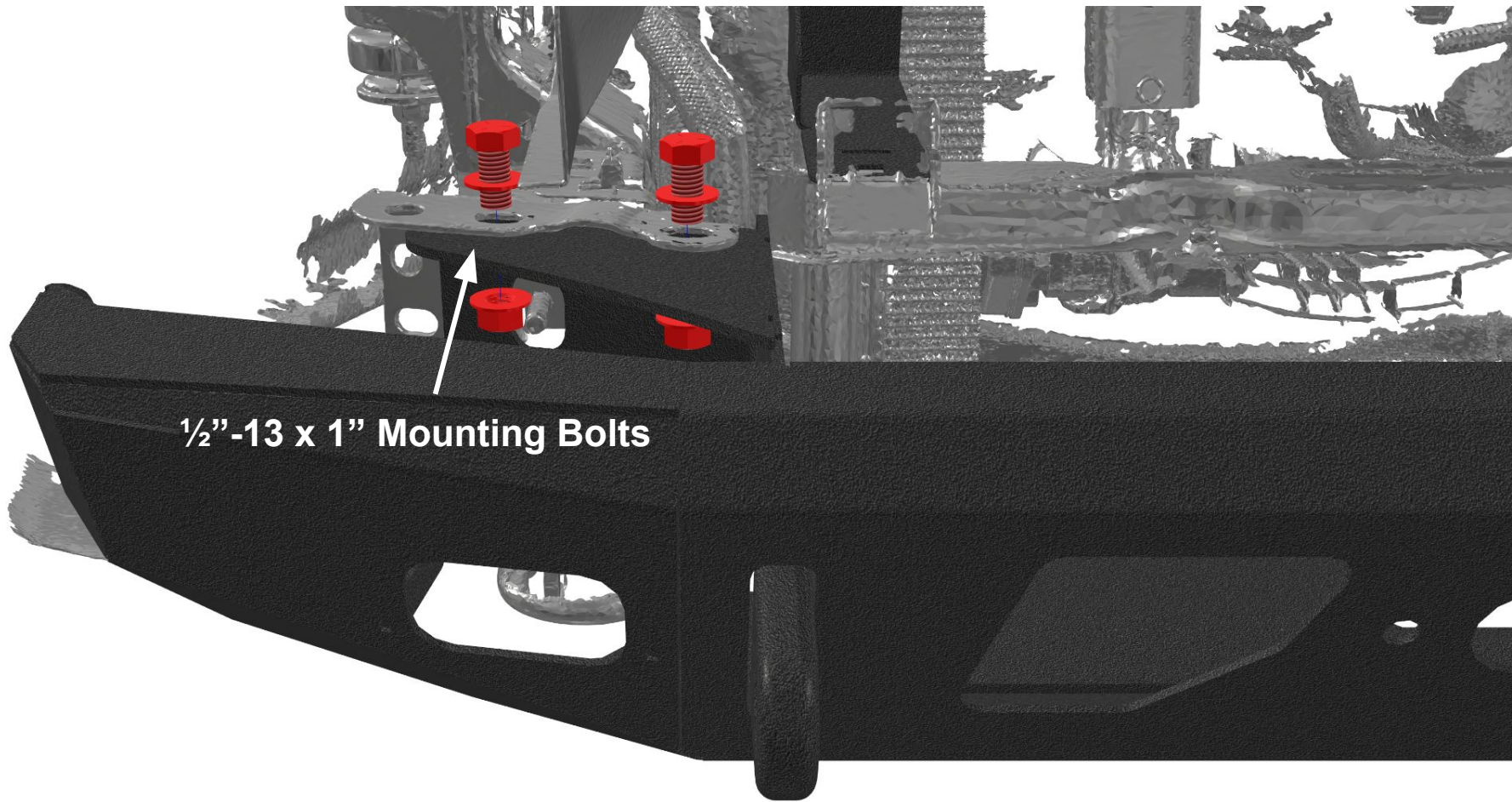

$\frac{1}{2}$ "-13 x 1" Mounting Bolts

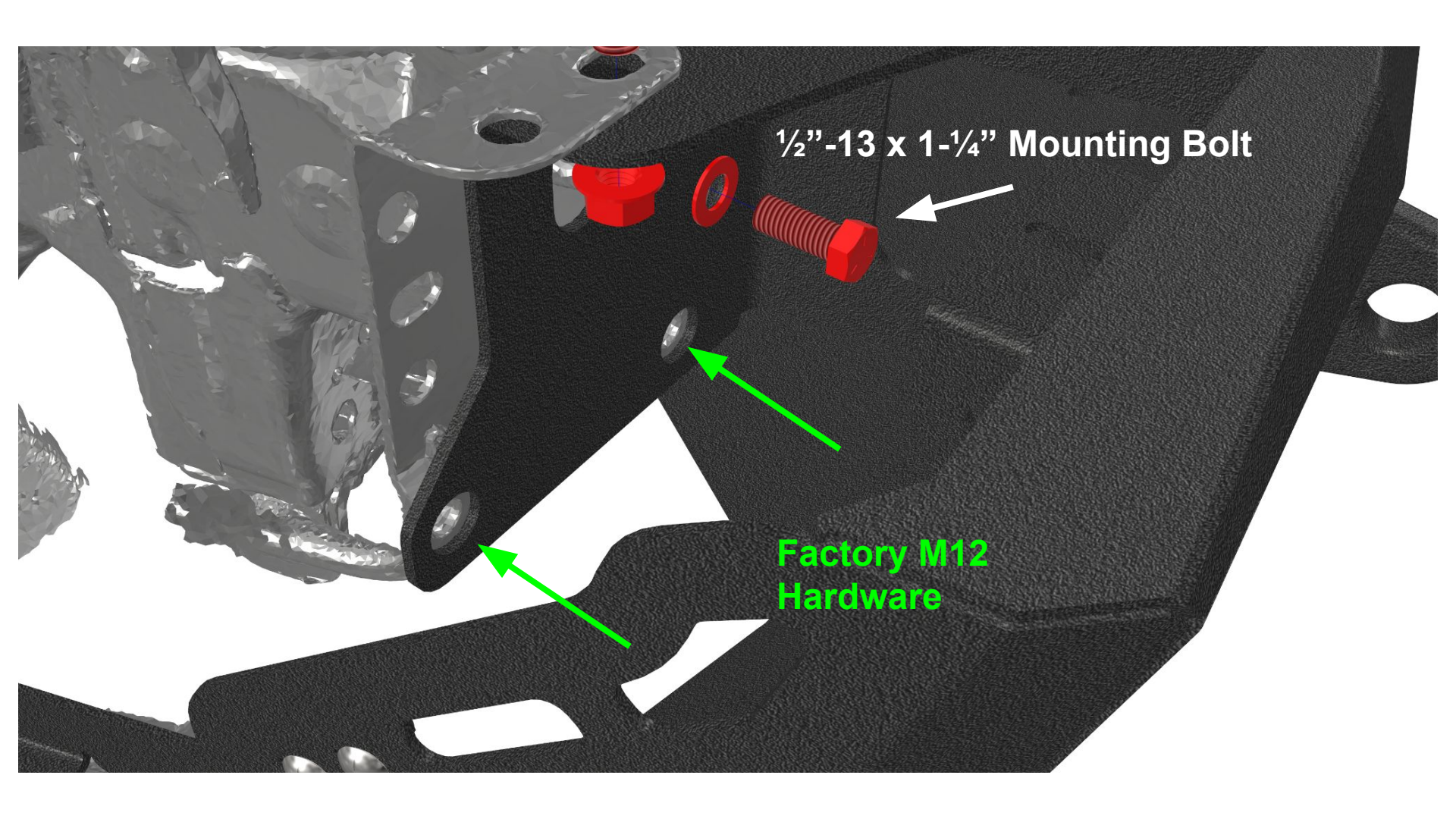

A 3D CAD model of a mechanical assembly. On the left is a grey, semi-transparent component with several circular holes. To its right is a black, solid component with a similar hole pattern. A red 1/2"-13 x 1-1/4" mounting bolt is shown in an exploded view, with a white arrow pointing to it. Two green arrows point to pre-drilled holes in the black component, labeled 'Factory M12 Hardware'.

1/2"-13 x 1-1/4" Mounting Bolt

**Factory M12
Hardware**

Step 5: Install Plastic Support Brackets

There are two sets of plastic support brackets supplied with the bumper, one set will support the front clip above the covert bumper, the other set will support and stiffen up the plastics on either side of the covert bumper

Install the upper plastic support brackets using the supplied six M6 flange screws, see image below, note that the brackets are side specific

The plastic clip retainers from the other brackets should have been moved to these supplied support brackets, the front clip has plastic prongs that will clip into these retainers

*on Pro and Trailhunter trims, some plastic guards may need to be removed, these can be seen in the image below

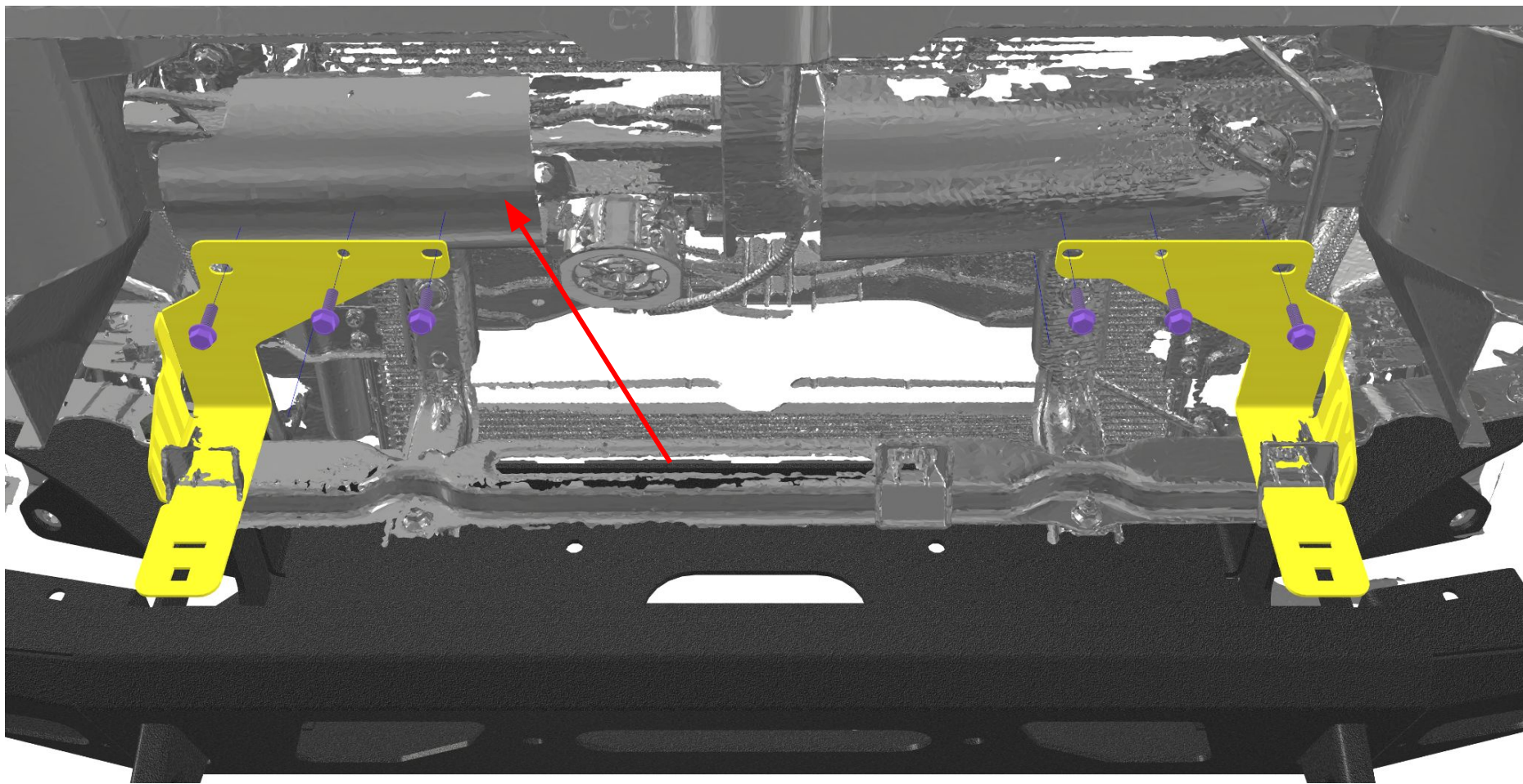

The side plastic support brackets are side specific

Install the side support brackets using the included 1/4" carriage bolts, washers, and nylon lock nuts, make sure the carriage bolts are pointing in towards the winch tray, these will likely require additional adjustment once the front clip is reinstalled

Once the front clip has been reinstalled, the sides will be attached to these brackets, a factory screw is reused as it has a small shoulder and will prevent the plastic from being crushed and breaking, an M6 nut (10mm socket) has been included for the factory screw

See image below

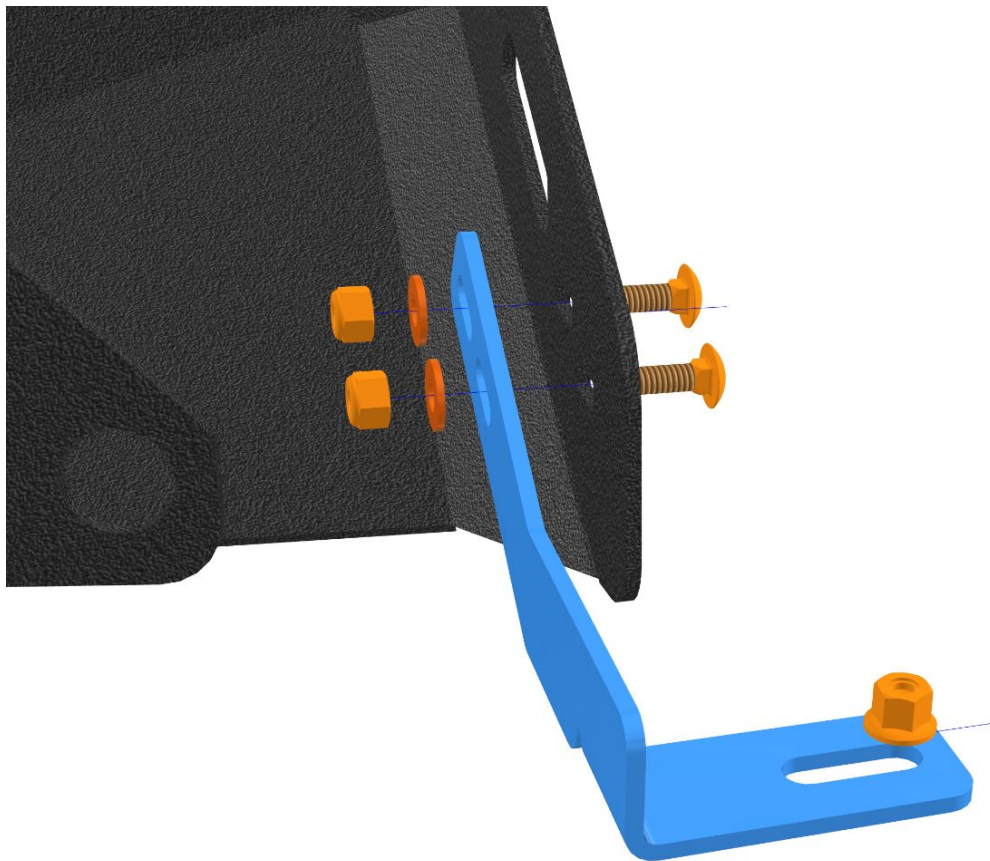

Step 6: Reassemble the front end

Once all accessory wiring has been completed, the front clip can be reinstalled

Carefully put the clip back into its original position and snap in any edges that lock into place

Attach the lower plastics to the side support brackets and make sure they are positioned correctly

Reinstall wheel well clips and screws, fender flares, structural screws, and covers

Plug in any loose wiring harness connectors